

Leakage control type ABS CA 461

SULZER

CA 461 is designed to spy and detect leakage in pumps and mixers. The amplifier is housed in a standard enclosure fitted for DIN-rail mounting.

The unit is available in two executions, 24 VDC or 110-230 VAC supply.

To minimize the risk of false alarms, the failure has to be detected for a duration of approximately 10 seconds.

To simplify the mounting, the unit is fitted with plug-in type connectors.

Features:

- Leakage monitoring with 10 sec alarm delay
- Wide resistance range, 0-100 kOhm
- Output 250 VAC 3 Ampere
- Connection via plug-in connectors
- DIN-rail mounted



Technical specifications

Description		Standard
Leakage sensor voltage		12 VDC
Max sensor current		< 15 μ A
Leakage detection threshold		< 100 kohm
Alarm on delay		10 seconds
Ambient operating temperature		-20 to +50 °C (-4 to +122 °F)
Ambient storage temperature		-30 to +80 °C (-22 to +176 °F)
Degree of protection		IP 20, NEMA: Type 1
Housing material		PPO and PC
Mounting		DIN Rail 35 mm
Installation category		CAT II
Pollution degree		2
Flame rate		V0 (E45329)
Humidity		0-95 % RH non-condensing
Dimensions		H x W x D: 108 x 35 x 58 mm (4.25 x 1.38 x 2.28 in.)
Power supply	16907010	110-230 VAC, 50 Hz/60 Hz
	16907011	18-36 VDC, SELV or Class 2
Fuse		Max 10 A
Terminal wire size		Use copper (Cu) wire only. 0.2 - 2.5 mm ² flexible core, stripped length 8 mm.
Terminal tightening torque		0.56 - 0.79 Nm (5-7 lbs-in)
Power consumption		< 2 W
Max load output		250 VAC 3 Ampere
Altitude		Max 2000 MASL or 6562 ft. AMSL
Compliance		CE  

Electrical connection diagram

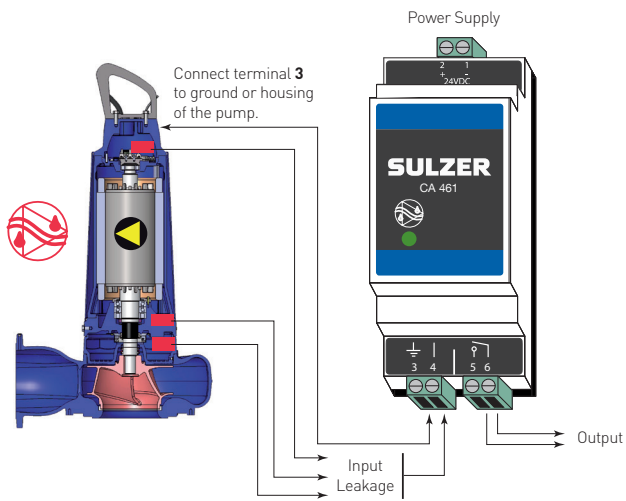

Dimensions

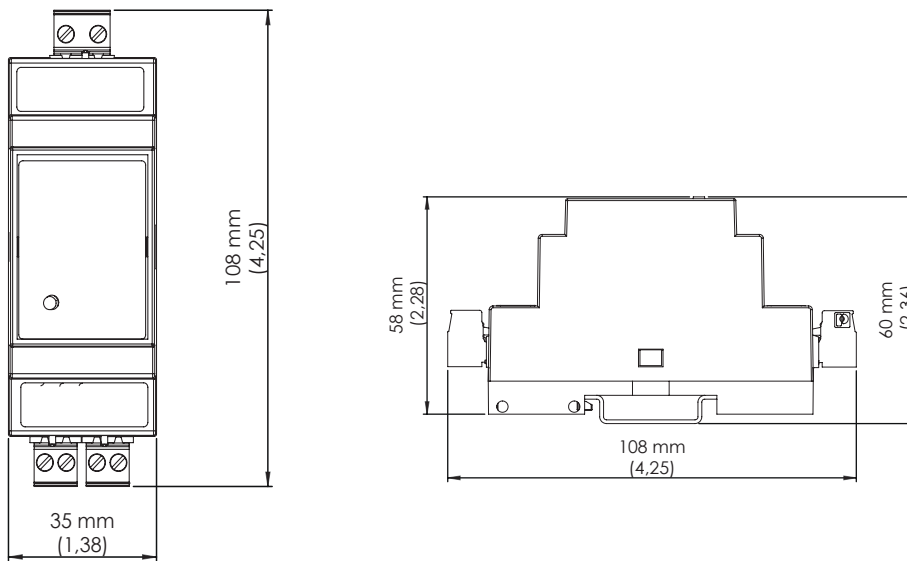

www.sulzer.com

CA 461 en (11.2019), Copyright © Sulzer Ltd 2019

This document does not provide a warranty or guarantee of any kind. Please contact us for a description of the warranties and guarantees offered with our products. Directions for use and safety will be given separately. All information herein is subject to change without notice.