

Sulzer ejector for priming Size L

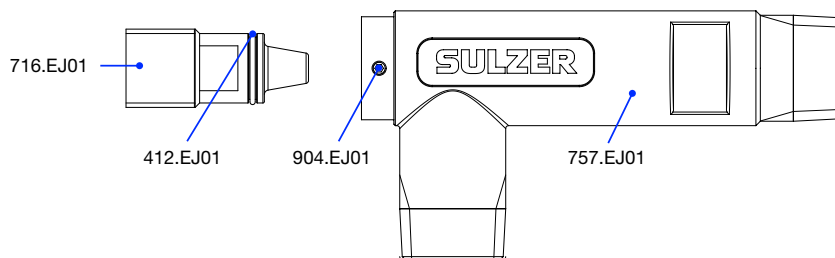

	CE version	US version
Air inlet connection	ISO 228 G3/4"	3/4" NPT
Suction connection	ISO 7/1 R1"	1" NPT
Outlet connection	ISO 7/1 R1"	1" NPT
Max. working temperature	90°C	194°F
Air inlet feed pressure	4 to 6 bar	58 to 87 psi
Air consumption	860 NI/min (6 bar)	32.3 SCFM (87 psi)
Priming capacity	up to 8 l/sec	up to 127 USgpm
Suction head	5...8 m (4-6 bar)	16.4...26.25 ft. (58-87 psi)



Materials

Ejector frame (757)	ASTM A890 Grade 3A, duplex steel
Ejector nozzle (716)	ASTM A890 Grade 3A, duplex steel
Set screw (904)	A4L-21H, ISO 3506-3
O-ring (412)	NBR70, ISO 3601-1

[sulzer.com](https://www.sulzer.com)

A10349 en 3.2023, Copyright © Sulzer Ltd 2023

This data sheet is a general product presentation. It does not provide a warranty or guarantee of any kind. Please contact us for a description of the warranties and guarantees offered with our products. Directions for use and safety will be given separately. All information herein is subject to change without notice.