

## Repair kit P/N 00833916 XJ 900 50/60 Hz

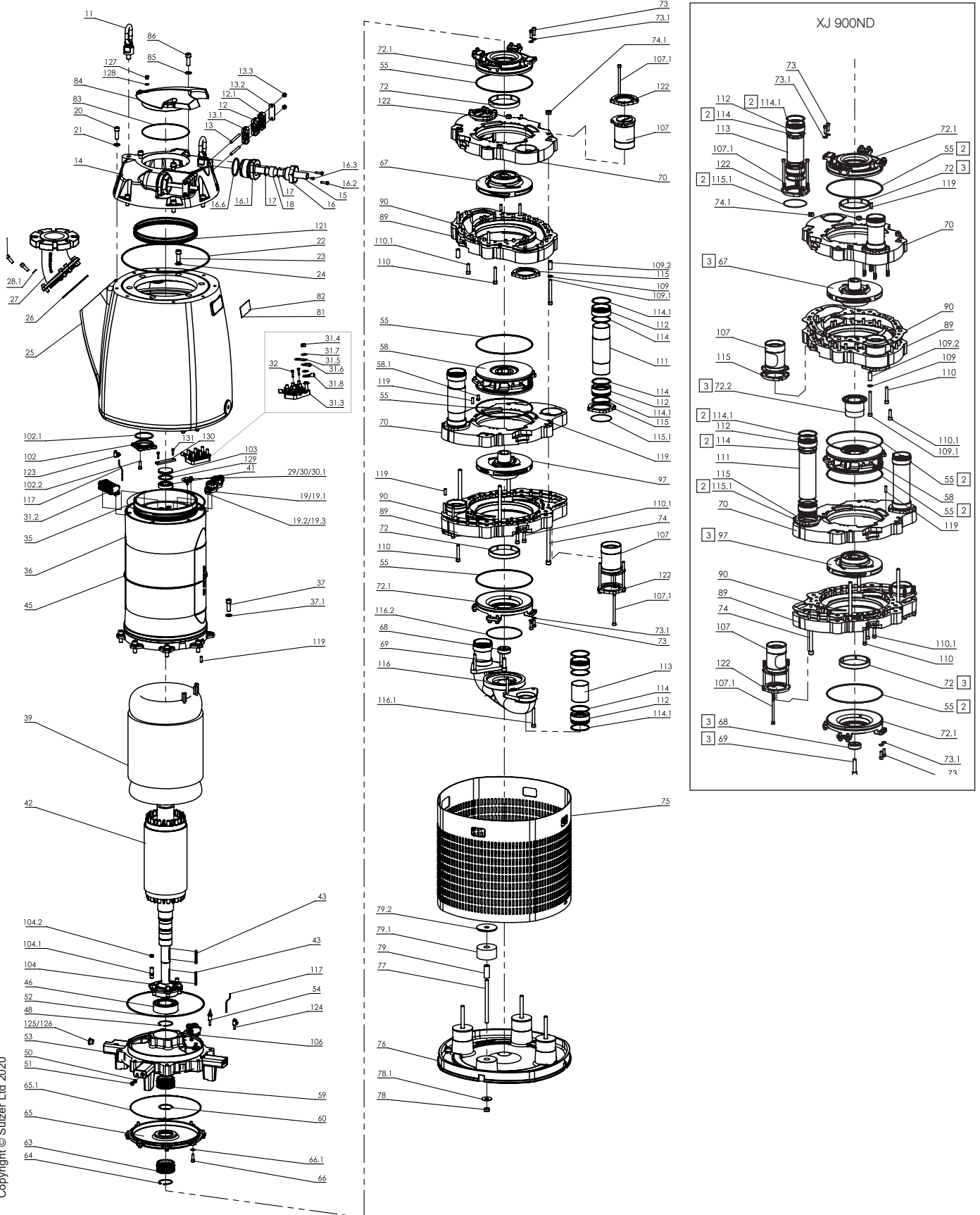

**Repair kit P/N 00833916 XJ 900**

| Pos nr<br>Item No<br>Pos.-Nr.<br>No de repérage<br>Posicion | Detalj nr<br>Part No.<br>Bestell-Nr.<br>No de pièce<br>Referencia | Benämning<br>Bezeichnung  | Denomination<br>Designation<br>Descripción   | Antal<br>Quantity<br>Anzahl<br>Nombre<br>Cantidad |
|---|---|---|--|---|
| 1   | 00833916  | SERVICESATS KOMPL.<br>SERVICESATZ KOMPL.                                  | SERVICE KIT COMPL.<br>JUEGO SERVICIO COMPL.<br>JUEGO SERVICIO COMPL.                               | 1   |
| 2   | 00833911  | O-RINGSSATS (Inkluderad i pos 1)<br>O-RINGSSATZ (in Pos 1 eingeschlossen) | O-RING KIT (included in pos 1)<br>JEU DE JOINTS (incl. in pos 1)<br>KIT DE JUNTAS (incl. in pos 1) | 1   |
| 16.6  | 11120084  | O-ring<br>O-ring  | O-ring<br>Joint torique<br>Junta torica  | 2   |
| 17  |   | Bricka<br>Scheibe   | Washer<br>Rondelle<br>Arandela   | 2/4   |
|   | 310200066002  | Ø25-Ø42   |  |   |
|   | 310200066008  | Ø39-Ø49   |  |   |
|   | 310200066009  | Ø42-Ø63   |  |   |
|   | 310200066011  | Ø47-Ø63   |  |   |
|   | 310200066012  | Ø50-Ø63   |  |   |
|   | 42010076  | Ø40-Ø19   |  |   |
| 18  |   | PACKNING<br>VERPACKUNG  | PACKING<br>EMBALLAGE<br>EMBALAJE   | 1/2   |
|   | 310200067001  | Ø23-Ø43   |  |   |
|   | 310200067002  | Ø25-Ø43   |  |   |
|   | 310200067003  | Ø43-Ø28   |  |   |
|   | 310200067004  | Ø30-Ø50   |  |   |
|   | 310200067005  | Ø32-Ø50   |  |   |
|   | 310200067006  | Ø34-Ø50   |  |   |
|   | 310200067007  | Ø36-Ø50   |  |   |
|   | 310200067008  | Ø39-Ø50   |  |   |
|   | 310200067009  | Ø42-Ø64   |  |   |
|   | 310200067010  | Ø44-Ø64   |  |   |
|   | 310200067011  | Ø47-Ø64   |  |   |
|   | 310200067012  | Ø50-Ø64   |  |   |
|   | 310200067013  | Ø53-Ø64   |  |   |
|   | 310200067014  | Ø19-Ø42   |  |   |
| 22  | 00833850  | O-ring<br>O-ring  | O-ring<br>Joint torique<br>Junta torica  | 1   |
| 26  | 00833187  | O-ring<br>O-Ring  | O-ring<br>Joint torique<br>Junta torica  | 1   |
| 35  | 11120203  | O-ring<br>O-Ring  | O-ring<br>Joint torique<br>Junta torica  | 1   |
| 41  | 00833855  | Kullager, övre<br>Kugellager, oben  | Ball bearing, upper<br>Roulement, supérieur<br>Rodamiento, superior                                | 1   |
| 43  | 11630038  | Plattkil<br>Flachkeil   | Flat key<br>Clavette<br>Chaveta  | 2   |
| 45  | 00833869  | O-ring<br>O-Ring  | O-ring<br>Joint torique<br>Junta torica  | 1   |
| 46  | 00833854  | Kullager, nedre<br>Kugellager, unten                                      | Ball bearing, lower<br>Roulement, inférieur<br>Rodamiento, inferior                                | 1   |

**Repair kit P/N 00833916 XJ 900**

| <b>Pos nr<br/>Item No<br/>Pos.-Nr.<br/>No de repérage<br/>Posicion</b> | <b>Detalj nr<br/>Part No.<br/>Bestell-Nr.<br/>No de pièce<br/>Referencia</b> | <b>Benämning<br/>Bezeichnung</b>          | <b>Denomination<br/>Designation<br/>Descripción</b>                    | <b>Antal<br/>Quantity<br/>Anzahl<br/>Nombre<br/>Cantidad</b> |
|--|--|---|--|--|
| 48   | 11080081   | Låsring<br>Nutring                        | Circlip<br>Circlips<br>Anillo de seguridad                             | 1  |
| 50   | 11130106   | Bricka<br>Scheibe                         | Washer<br>Rondelle<br>Arandela   | 5  |
| 52   | 11120575   | O-ring<br>O-Ring                          | O-ring<br>Joint torique<br>Junta torica                                | 1  |
| 55   | 00833146   | O-ring<br>O-Ring                          | O-ring<br>Joint torique<br>Junta torica                                | 4  |
| 59   | 00833856   | Sekundärtätning<br>Sekundärdichtung       | Secondary seal<br>Etanchéité secondaire<br>Junta secundario            | 1  |
| 60   | 11070014   | Låsring<br>Nutring                        | Circlip<br>Circlips<br>Anillo de seguridad                             | 1  |
| 63   | 00833856   | Primärtätning<br>Primärdichtung           | Primary seal<br>Etanchéité primaire<br>Junta primario                  | 1  |
| 64   | 11070037   | Låsring<br>Nutring                        | Circlip<br>Circlips<br>Anillo de seguridad                             | 1  |
| 65.1   | 00833852   | O-ring<br>O-Ring                          | O-ring<br>Joint torique<br>Junta torica                                | 1  |
| 83   | 11120620   | O-ring<br>O-Ring                          | O-ring<br>Joint torique<br>Junta torica                                | 1  |
| 102.1  | 11120084   | O-ring HD<br>O-Ring HD                    | O-ring HD<br>Joint torique HD<br>Junta torica HD                       | 2  |
| 114  | 11121149   | O-ring<br>O-Ring                          | O-ring<br>Joint torique<br>Junta torica                                | 16   |
| 114.1  | 11120084   | O-ring<br>O-Ring                          | O-ring<br>Joint torique<br>Junta torica                                | 16   |
| 115.1  | 11120730   | O-ring<br>O-Ring                          | O-ring<br>Joint torique<br>Junta torica                                | 4  |
| 116.2  | 11120728   | O-ring (endast HD)<br>O-Ring (nur bei HD) | O-ring (HD only)<br>Joint torique (seulement en HD)<br>Junta torica HD | 1  |
| 121  | 11120849   | O-ring<br>O-Ring                          | O-ring<br>Joint torique<br>Junta torica                                | 3  |
| 126  | 11130043   | Bricka<br>Scheibe                         | Washer<br>Rondelle<br>Arandela   | 1  |
| 128  | 11130106   | Bricka<br>Scheibe                         | Washer<br>Rondelle<br>Arandela   | 1  |

**Repair kit P/N 00833916 XJ 900**

| <b>Pos nr<br/>Item No<br/>Pos.-Nr.<br/>No de repérage<br/>Posicion</b> | <b>Detalj nr<br/>Part No.<br/>Bestell-Nr.<br/>No de pièce<br/>Referencia</b> | <b>Benämning<br/>Bezeichnung</b>        | <b>Denomination<br/>Designation<br/>Descripcion</b>                                  | <b>Antal<br/>Quantity<br/>Anzahl<br/>Nombre<br/>Cantidad</b> |
|--|--|---|--|--|
| 129  | 11060012   | Stödbricka<br>Stützscheibe              | Support washer<br>Rondelle support<br>Arandela de soporte                            | 1  |
| 130  | 310101557001   | Lagerlocksöverfall<br>Lagerdeckelhalter | Bearing cover clamp<br>Bride de couvercle palier<br>Fijador de la tapa de rodamiento | 1  |
| 131  | 11210240   | Skruv<br>Schraube                       | Screw<br>Vis<br>Tornillo   | 2  |